



# DRUMSTANDS



## Aluminium drumstands

Sahlins aluminium lightweight drumstands with wheels are very easy to transport and set up. The large base plates make them very stable. The drumshaft is fitted with slide bearings for easy rotation. Aluminium spacers hold, and centre the drum on the shaft. The hydraulic jacks are equipped with hard chromium plated piston rods to prevent rust. Two sizes of the drumstand are available.



## Steel drumstands

Sahlins steel drumstands are completely galvanized and of a very rugged construction. The hydraulic jacks are equipped with hard chromium plated piston rods. Aluminium spacers centre and hold the drum on the shaft.

A drumshaft diam. 60mm with slide bearings is also available.

### TECHNICAL DATA/ ALUMINIUM

Art.no.	6401-0040	6401-0060
Max.load:	4000kg	6000kg
Drum diam.:	2000mm	2800mm
Height:	1080mm	1635mm
Weight/2sides.	38 kg	64kg
Shaft diam.:	60mm	60mm
Shaft length:	1440mm	1830mm
Shaft weight:	17kg	22kg
Baseplate:	350x600	420x670mm

### TECHNICAL DATA/STEEL

Art.no.	6402-0050	6402-0030
Max.load:	5000kg	3000kg
Drum.diam.:	2600mm	2000mm
Height:	1600mm	1280mm
Weight/2sides:	60kg	48kg
Shaft diam.:	63mm	63mm
Shaft length:	2000mm	2000mm
Shaft weight:	28kg	28kg



Cable drum stand with brake and mechanically operated lifting jack. The drum has adjustable lifting arms. A light yet solid construction.

Drum size: K9 - K18 - 3 tonnes

Weight: 113 kg

Art.No.: 6400-0031



A robust cable drum stand with brake and hydraulically operated lifting jack. The pump and piston rods are chromium-plated.

Drum size: K30 - 10 tonnes

Weight: 515 kg

Art.No.: 6400-0100

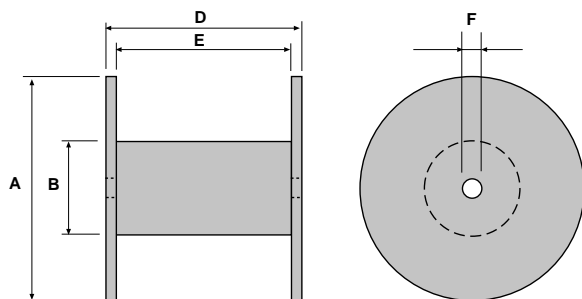

**TECHNICAL DATA**

	<b>K8</b>	<b>K9</b>	<b>K10</b>	<b>K12</b>	<b>K14</b>	<b>K16</b>	<b>K17</b>	<b>K18</b>	<b>K19</b>	<b>K21</b>	<b>K24</b>	<b>K26</b>	<b>K28</b>	<b>K30</b>
<b>A</b>	800	900	1000	1200	1400	1600	1700	1800	1900	2100	2400	2600	2800	3000
<b>B</b>	375	425	500	675	800	950	950	1100	1100	1300	1400	1500	1500	1500
<b>D</b>	576	626	710	982	982	1016	1016	1016	1016	1190	1204	1452	1654	1804
<b>E</b>	500	550	600	850	850	850	850	850	850	1000	1000	1200	1350	1500
<b>F</b>	75	75	106	106	106	106	106	132	132	132	132	132	132	132
<b>W</b>	25	34	46	90	120	195	218	230	255	360	450	900	1180	1500